

## SPECIFICATION

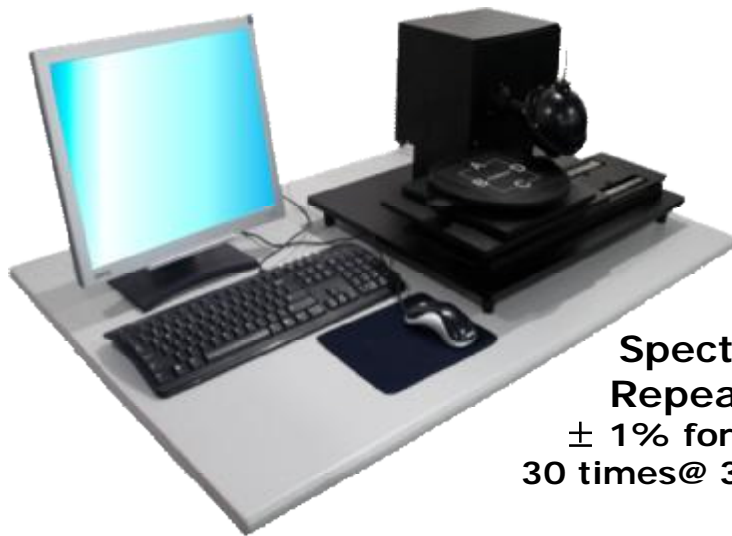

Spectral range : 350 – 1050 nm  
Repeatability :  
± 1% for D/8 standard calibration sample  
30 times@ 350~1050nm

## STANDARD FEATURES

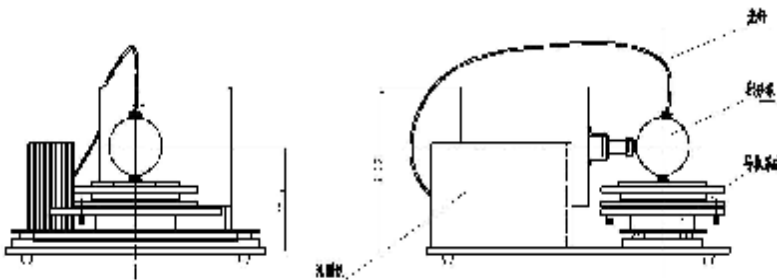

### Source Module

ØLamp: Xenon Lamp  
ØLife time : 3000hrs  
ØWavelength: 220nm ~ 2500nm

### Sample Holder

ØManual adjustment on 2 axis  
ØSample dimensions: up to  $\Phi$  125mm and 156 mm  
Ømax thickness of 1 mm

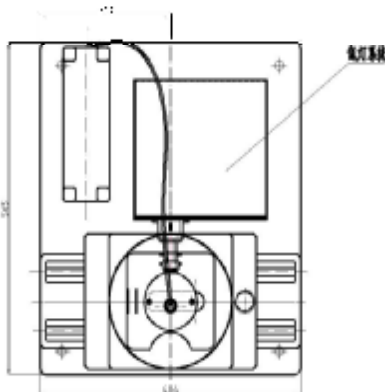

### D/8 Reflectance Measurement Integrating Sphere

ØSpecial design to match with International D8 standard criterion

### Special Design Ultra High Sensitivity Spectrometer

#### Controller

ØPC-Based control system:  
ØProcessor Speed 1.5 GHz,  
ØDDR : 512 MB, Hard Disk > 80GB,  
ØCD/DVD-ROM  
ØScreen : 17" TFT-LCD Display

ØMulti-channel Spectragraph  
Ø Spectral Range : 330 nm – 1050 nm  
Ø Resolution : 1.0 nm  
ØHermetical sealed  
ØWavelength stability : < 0.05 nm over 48HRS  
ØLow Read out noise: 8 electron rms  
ØWide dynamic range:16 bit

# SOFTWARE FEATURE

WIN-D/8 is the most comprehensive program available for data acquisition and process. It combines algorithms with a large selection of AM 0/1/1.5G options for fast, accurate data composition.

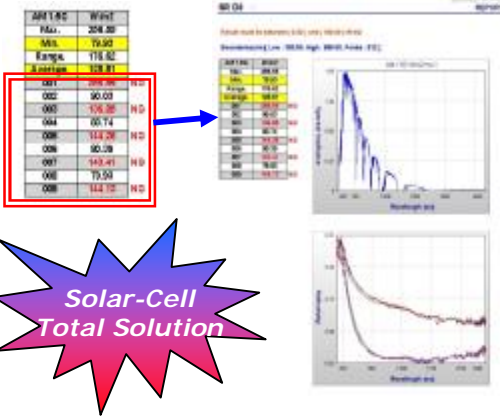

WIN-D/8 Smart Background, Diffuse-Standard R% calibration and Automated measurement Software

Operator and Engineer mode architecture  
R% calculation, composite with Air Mass  
Alarm Range Setting by QC  
Report Capability

# APPLICATIONS

